

# C BUILDING - LEVEL 400

## KEY

- TENANT A  
14,963 RSF
- TENANT B  
LEASED
- TENANT C  
LEASED

## CAMPUS MAP

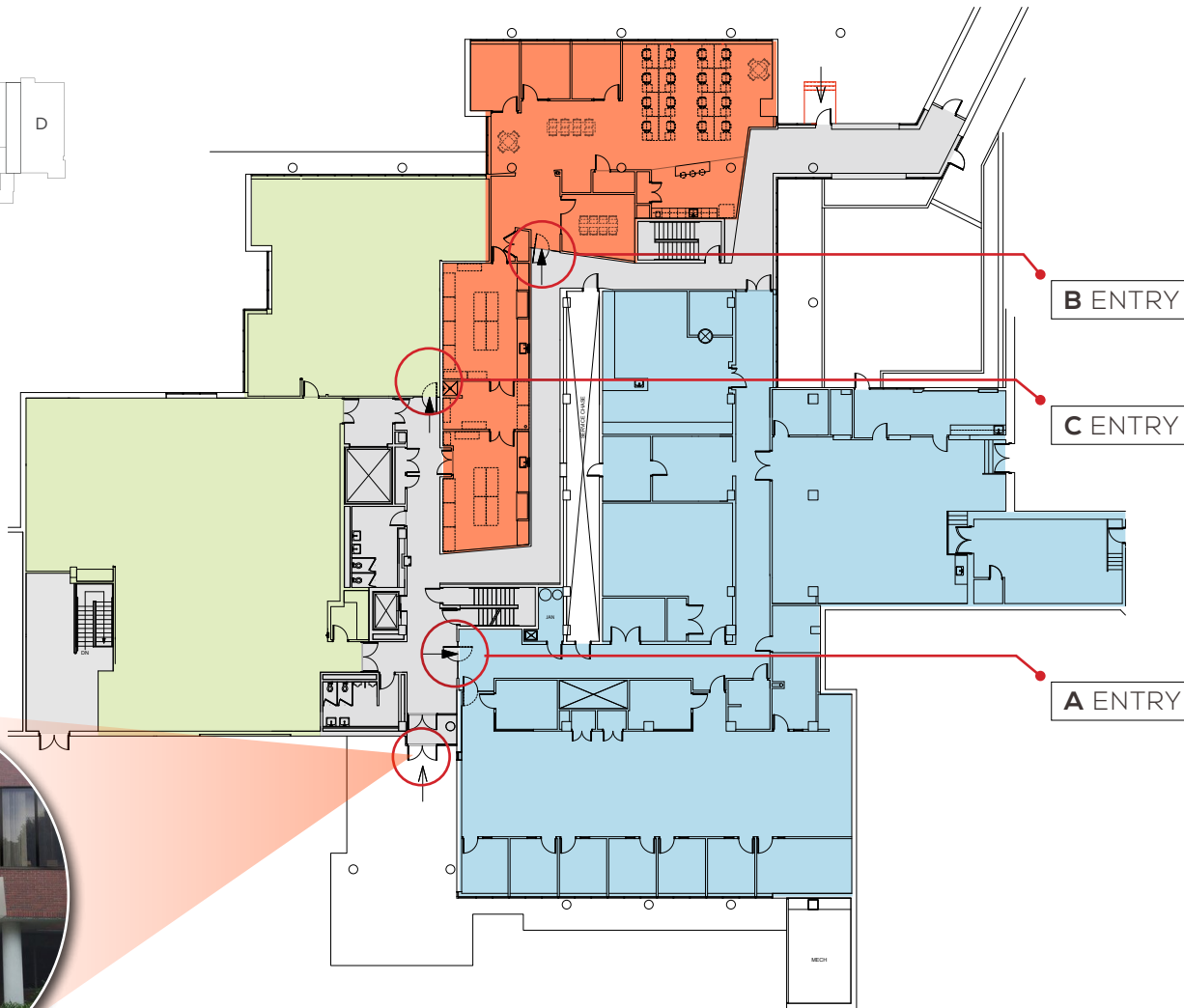
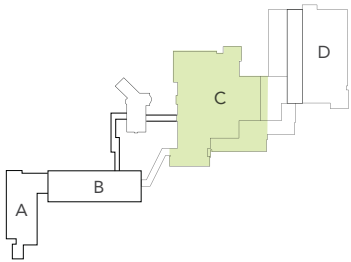

# LAB SPECIFICATIONS

## C BUILDING: LEVEL 400

	TENANT A
Square Footage:	14,963 RSF
Office/Lab Ratio:	50% Office / 50% Lab
Offices:	6
Conference Room:	3
Hoods:	(3) 4 foot hoods and several point exhaust locations.
Kitchenette:	0
HVAC Systems:	Office space and lab space served by a 115 ton, McQuay rooftop unit (air cooled DX, gas heat). Office served by fan powered VAV terminal units and single duct VAV terminal units with hot water reheat coils. Lab space served by single duct VAV terminal units with hot water reheat coils. 6 ton air handling unit also serves the lab space. 4 ductless split systems.
Plumbing:	Base Building central RODI system. Base Building central compressed air system. Base building central Non-Potable hot and cold water systems. Base building central tepid water system serves emergency showers and eye wash stations. Base building pH Neutralization system. Domestic cold water, sanitary and vent piping serves the office area.
Electrical:	100A 120/208V normal power panel serves the lab space. 100A 120/208V normal power panel serves the office space.
Emergency Backup:	150 kW base building standby diesel generator, tenant is allotted 5 W/sf of standby power for the lab space (assumed 50% lab / 50% office).